

Km/h	25	40
17/39	X	X
17/40		X
21/39	X	X
21/40		X
23/45	X	

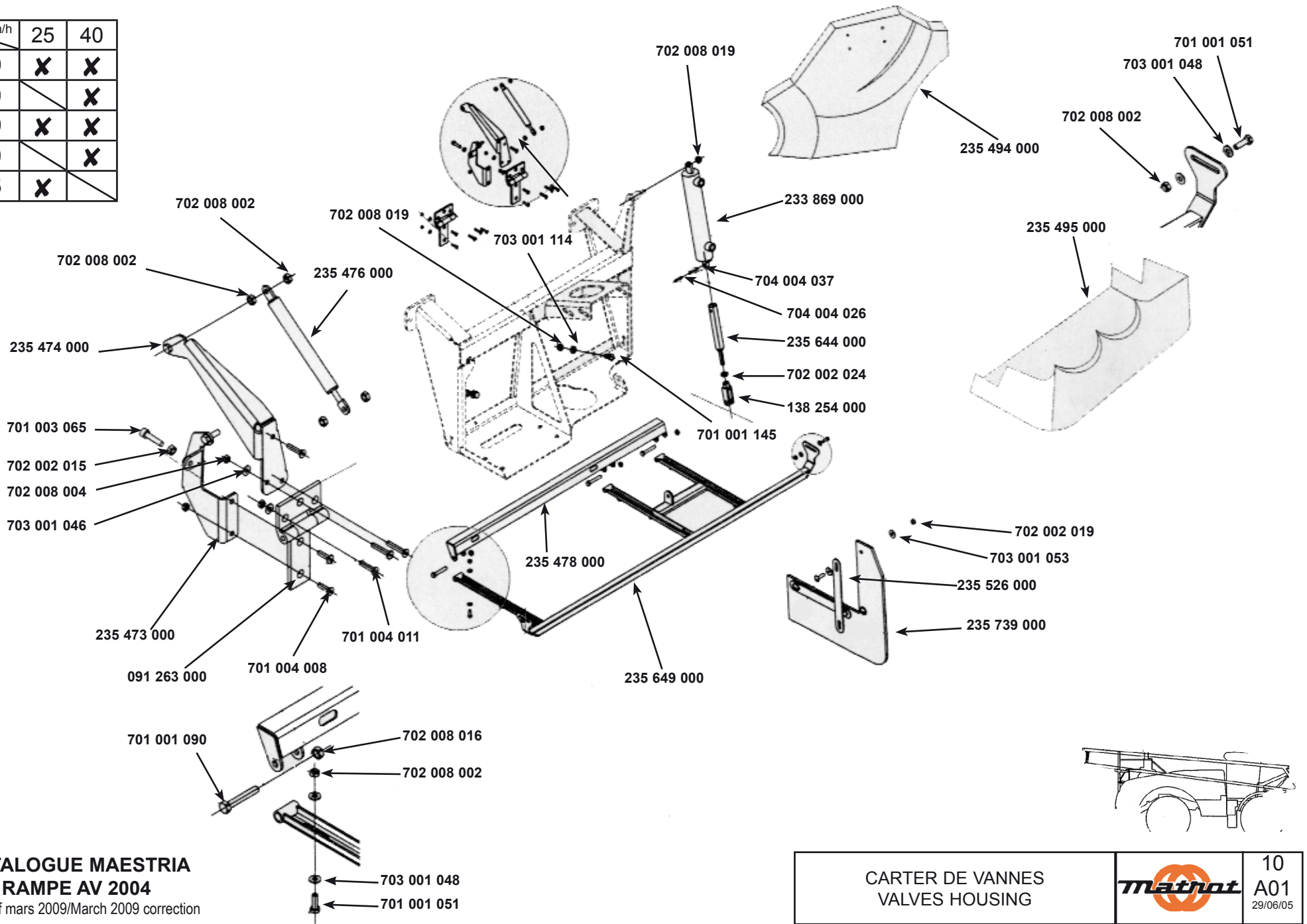

CATALOGUE MAESTRIA
RAMPE AV 2004
 Correctif mars 2009/March 2009 correction

CARTER DE VANNES VALVES HOUSING		10 A01 29/06/05
------------------------------------	---------------------------------------------------------------------------------------	-----------------------

Km/h	25	40
17/39	X	X
21/39	X	X
23/45	X	

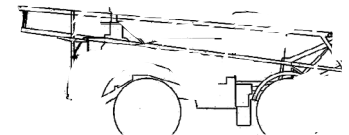
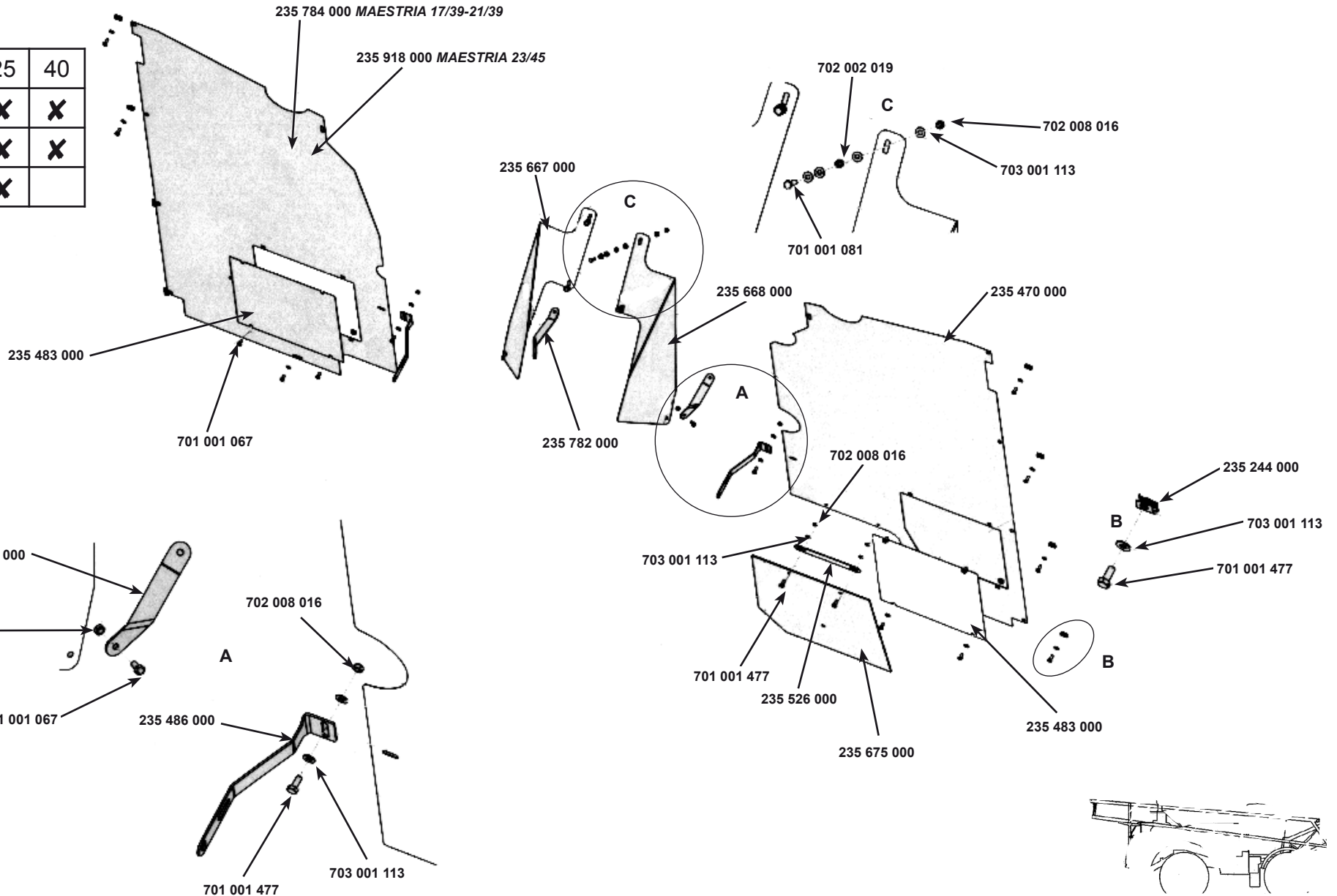

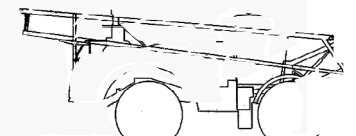
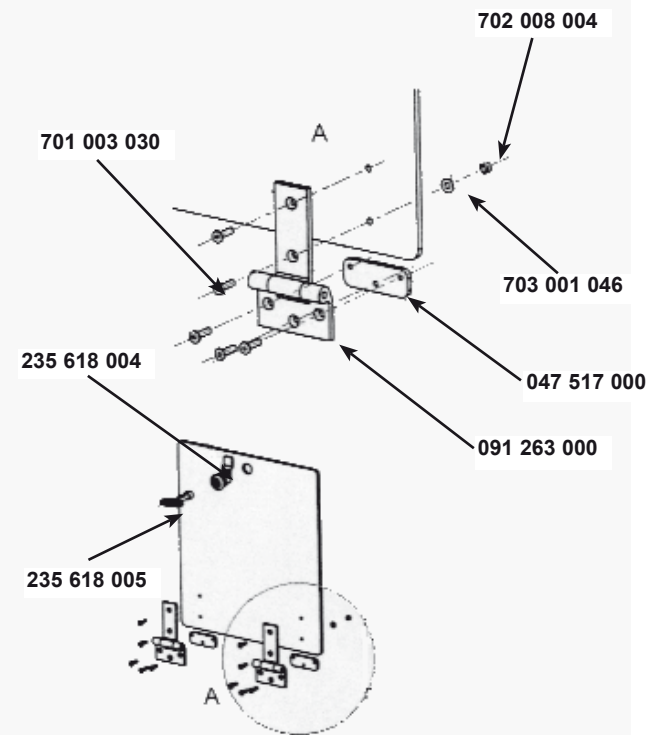
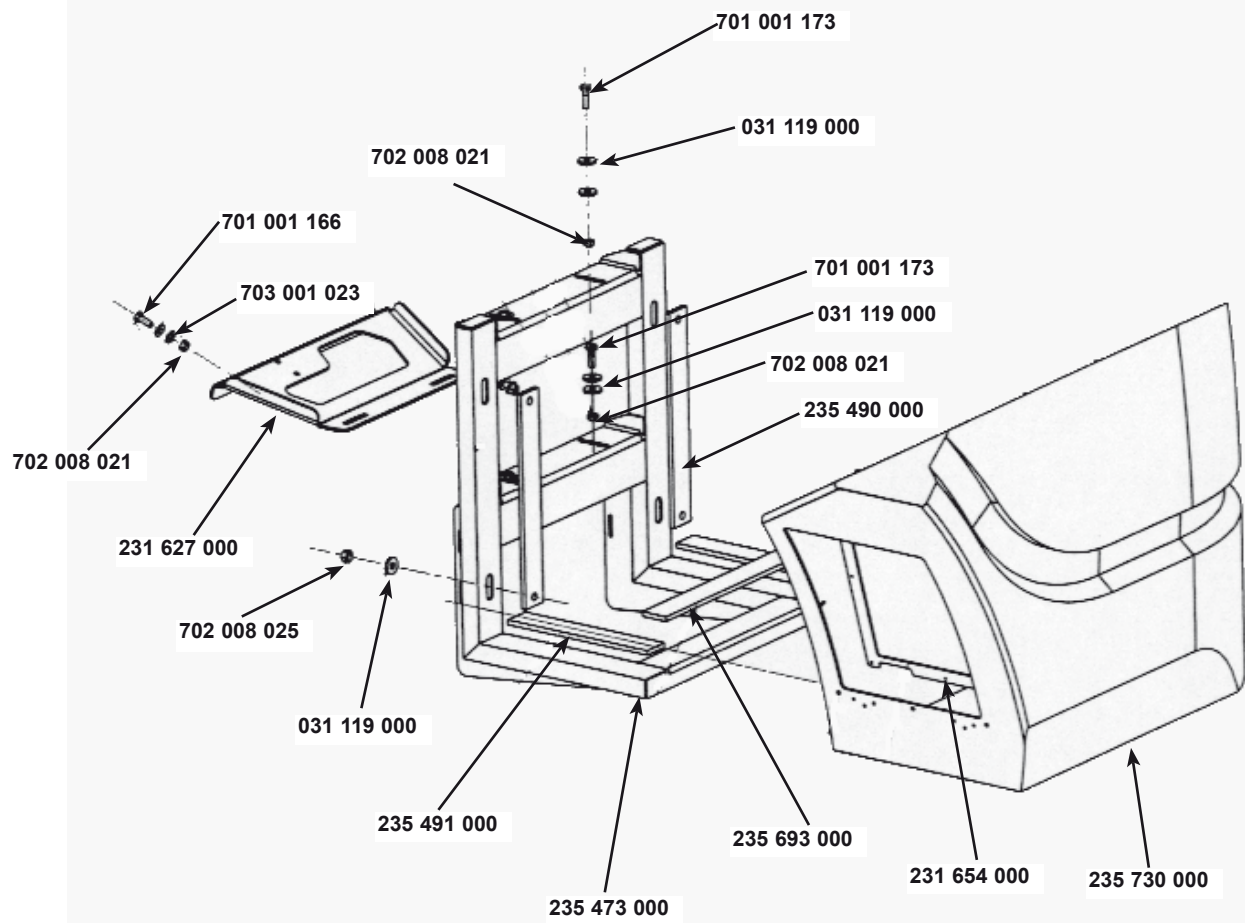

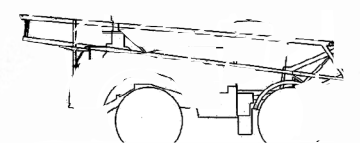
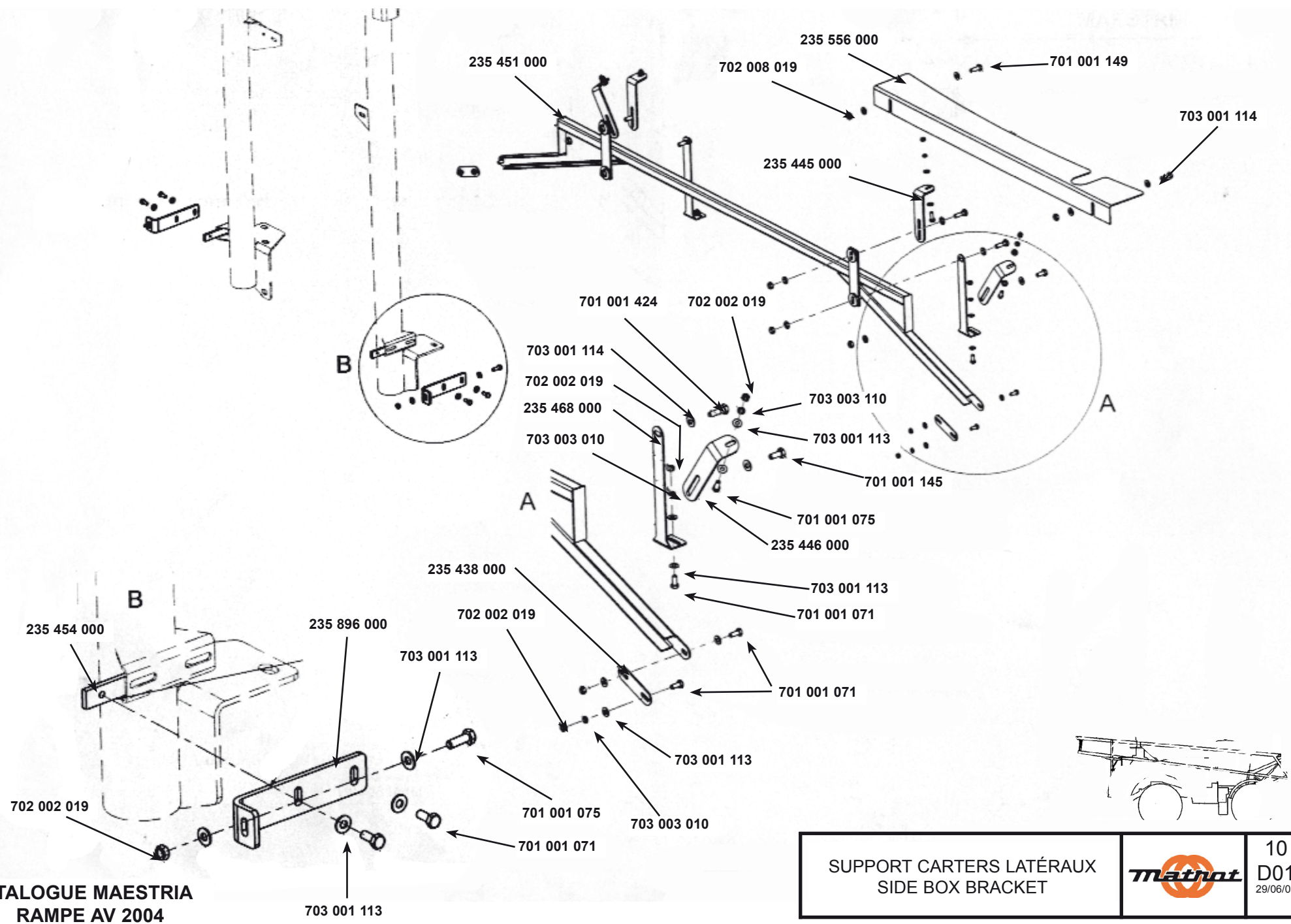

CATALOGUE MAESTRIA
RAMPE AV 2004

SUPPORT CARTERS LATÉRAUX SIDE BOX BRACKET		10 D01 29/06/05
----------------------------------------------	---------------------------------------------------------------------------------------	-----------------------

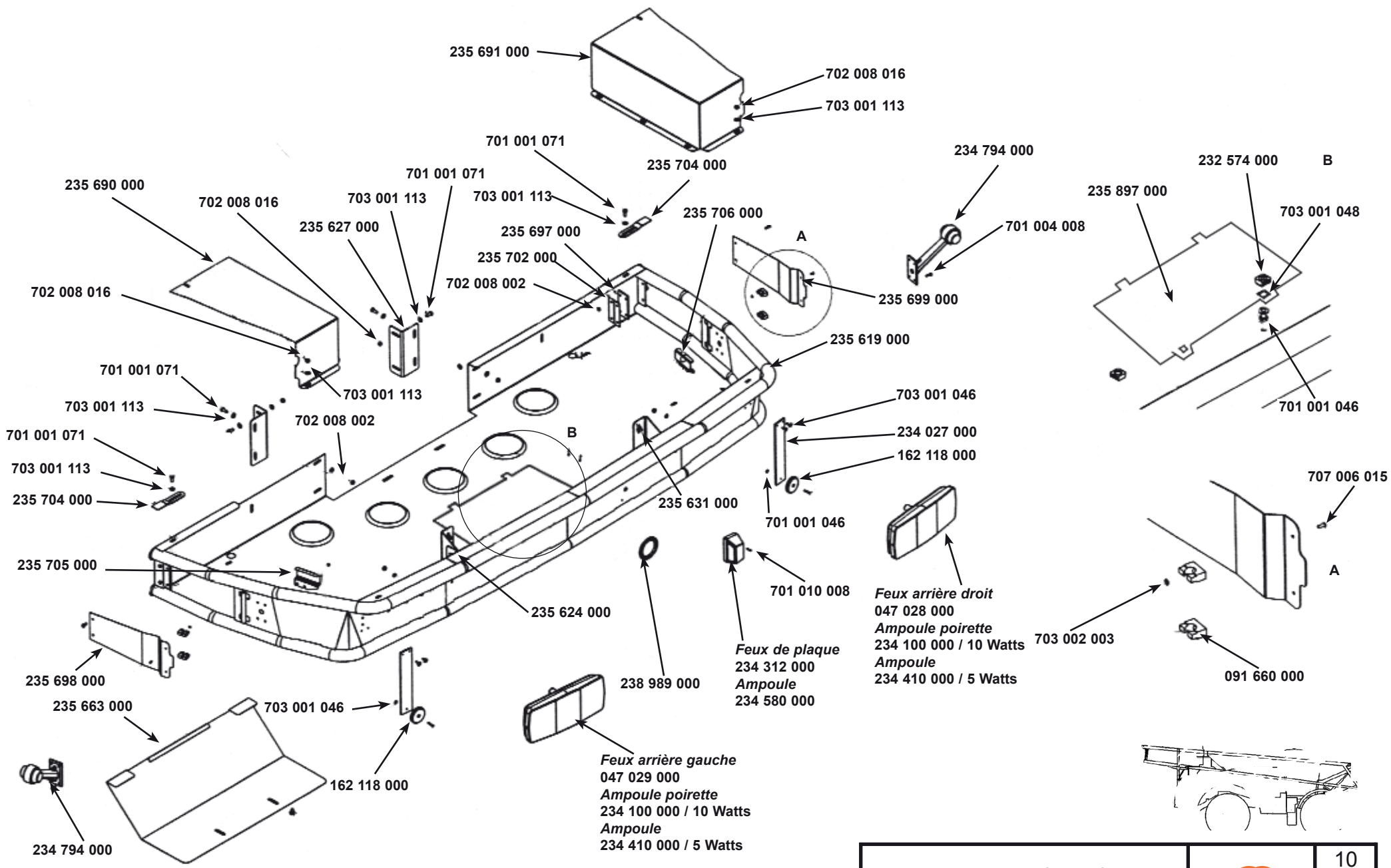

Modèles \ Km/h	25	40
17/39	X	X
17/40		X
21/39	X	X
21/40		X
23/45	X	

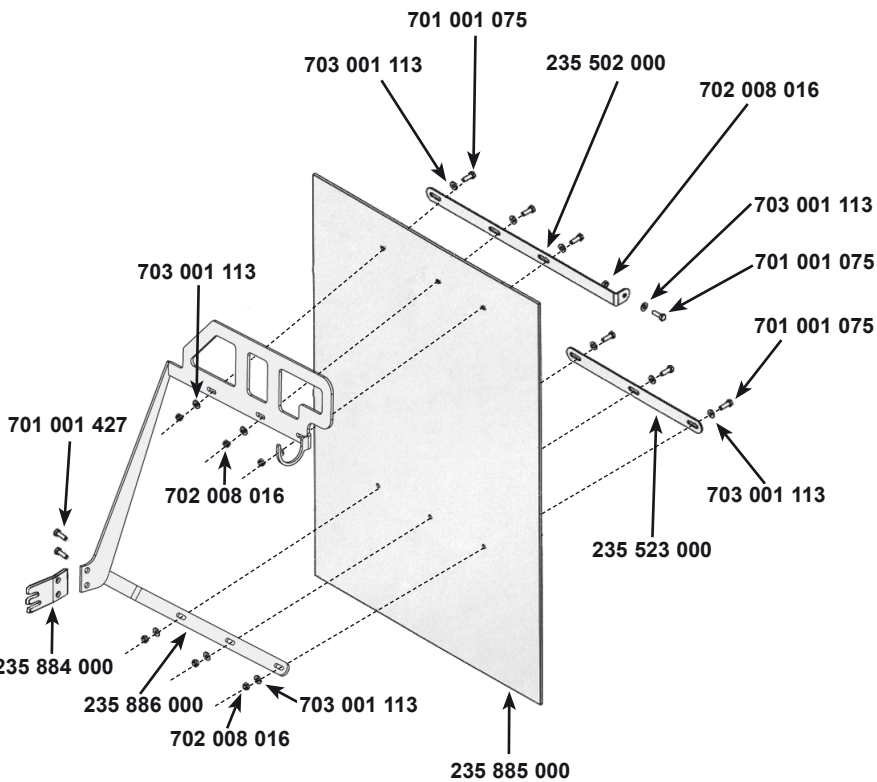

Bavette gauche
Left flap

**CATALOGUE MAESTRIA
RAMPE AV 2004**

Correctif mars 2009/March 2009 correction

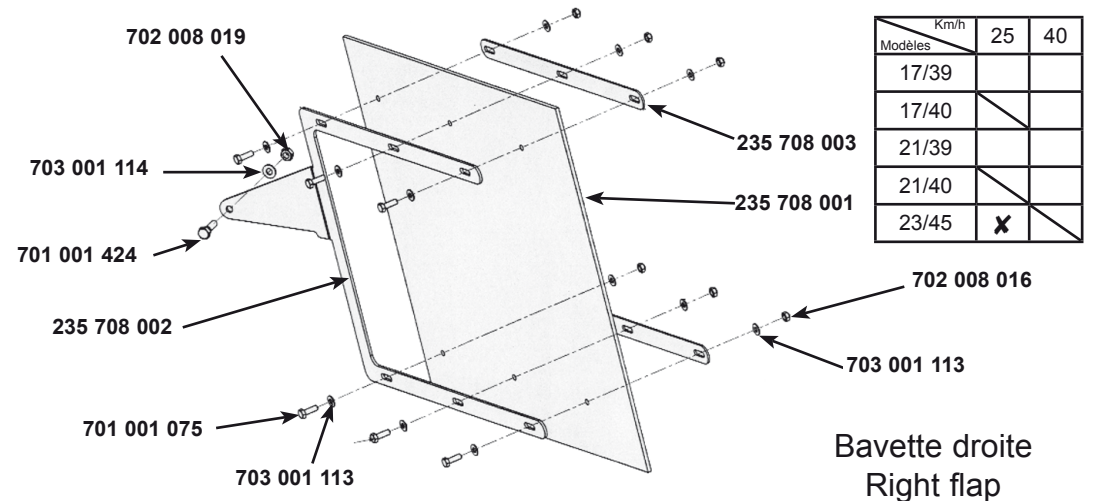

Bavette droite
Right flap

Modèles \ Km/h	25	40
17/39		
17/40		
21/39		
21/40		
23/45	X	

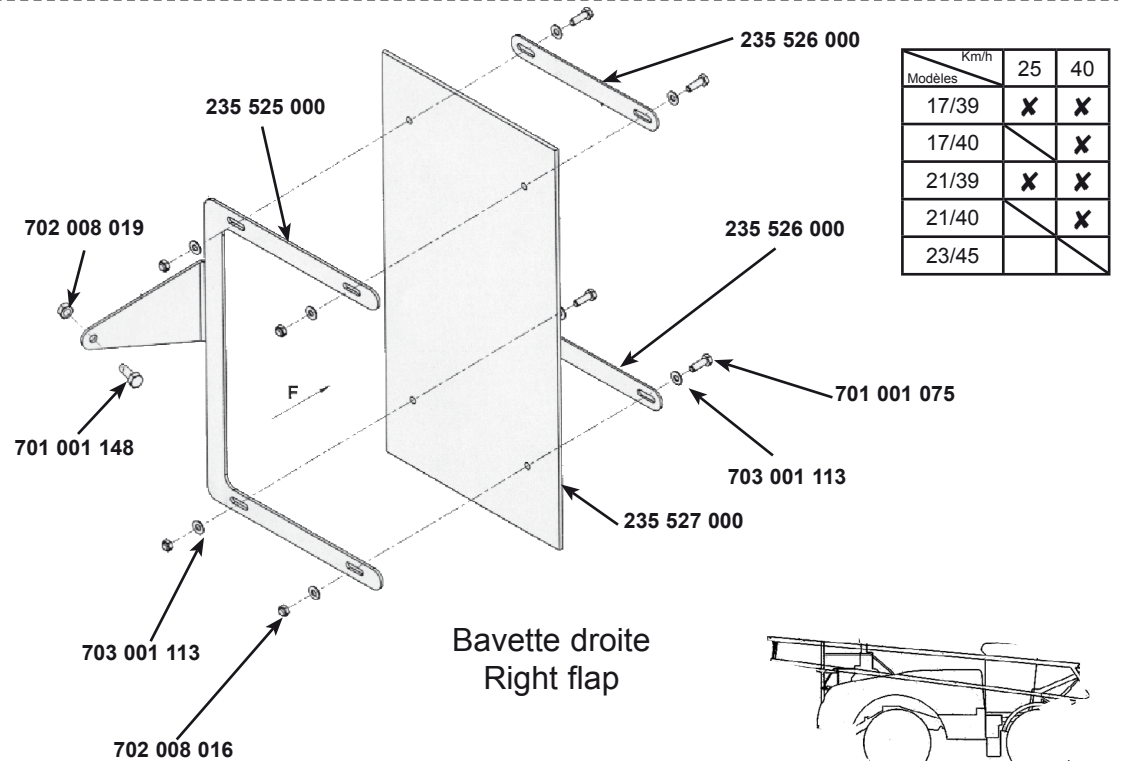

Bavette droite
Right flap

Modèles \ Km/h	25	40
17/39	X	X
17/40		X
21/39	X	X
21/40		X
23/45		

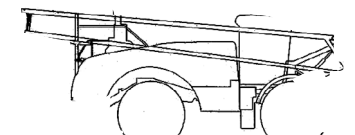

BAVETTES
FLAPS



10
F01
30/05/05

Modèles \ Km/h	25	40
17/39	X	X
17/40		X
21/39	X	X
21/40		X
23/45	X	

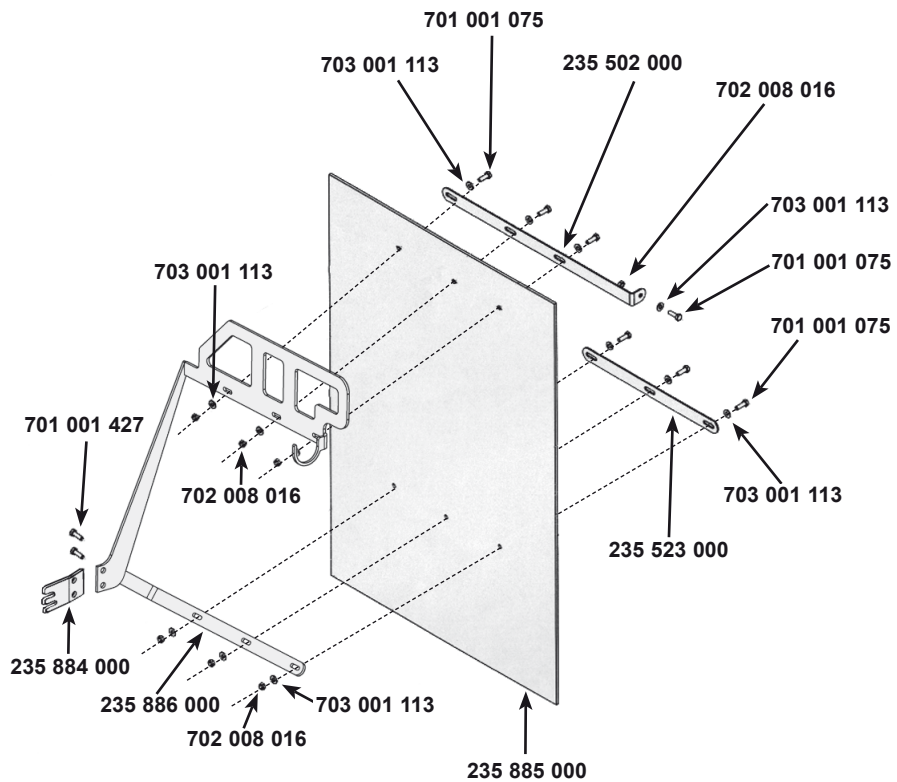

Bavette gauche
Left flap

**CATALOGUE MAESTRIA
RAMPE AV 2004**

Correctif mars 2009/March 2009 correction

Modèles \ Km/h	25	40
17/39	X	X
17/40		X
21/39	X	X
21/40		X
23/45	X	

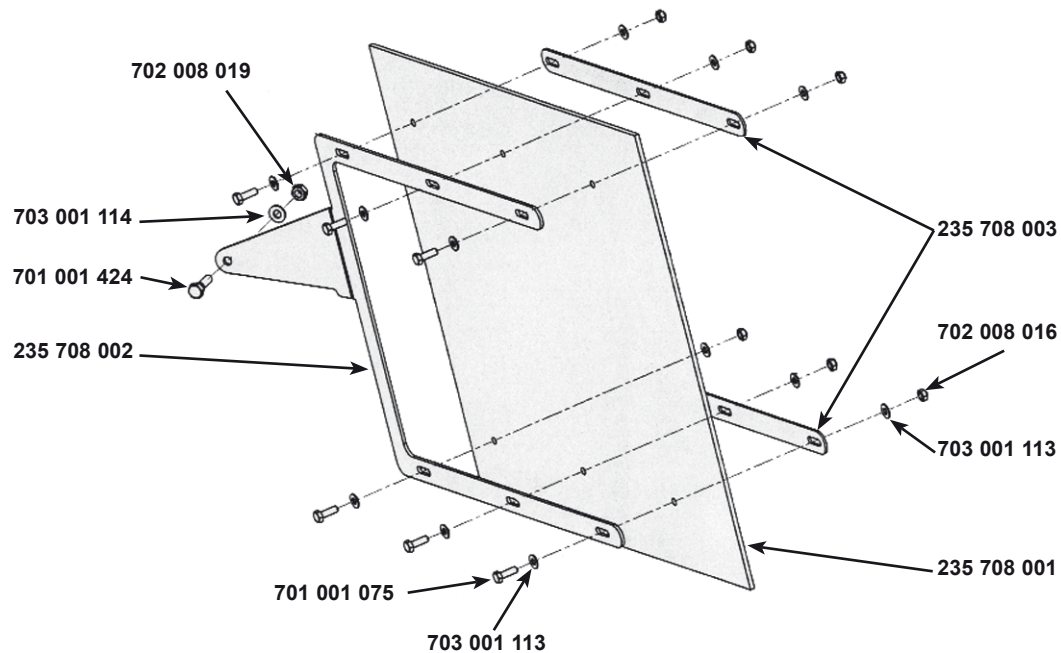

Bavette droite
Right flap

BAVETTES VERSION STABILIS®
FLAP'S STABILIS® VERSION



10
F02
24/03/06

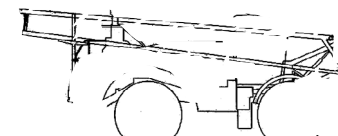

Km/h	25	40
17/39	X	X
17/40		X
21/39	X	X
21/40		X
23/45	X	

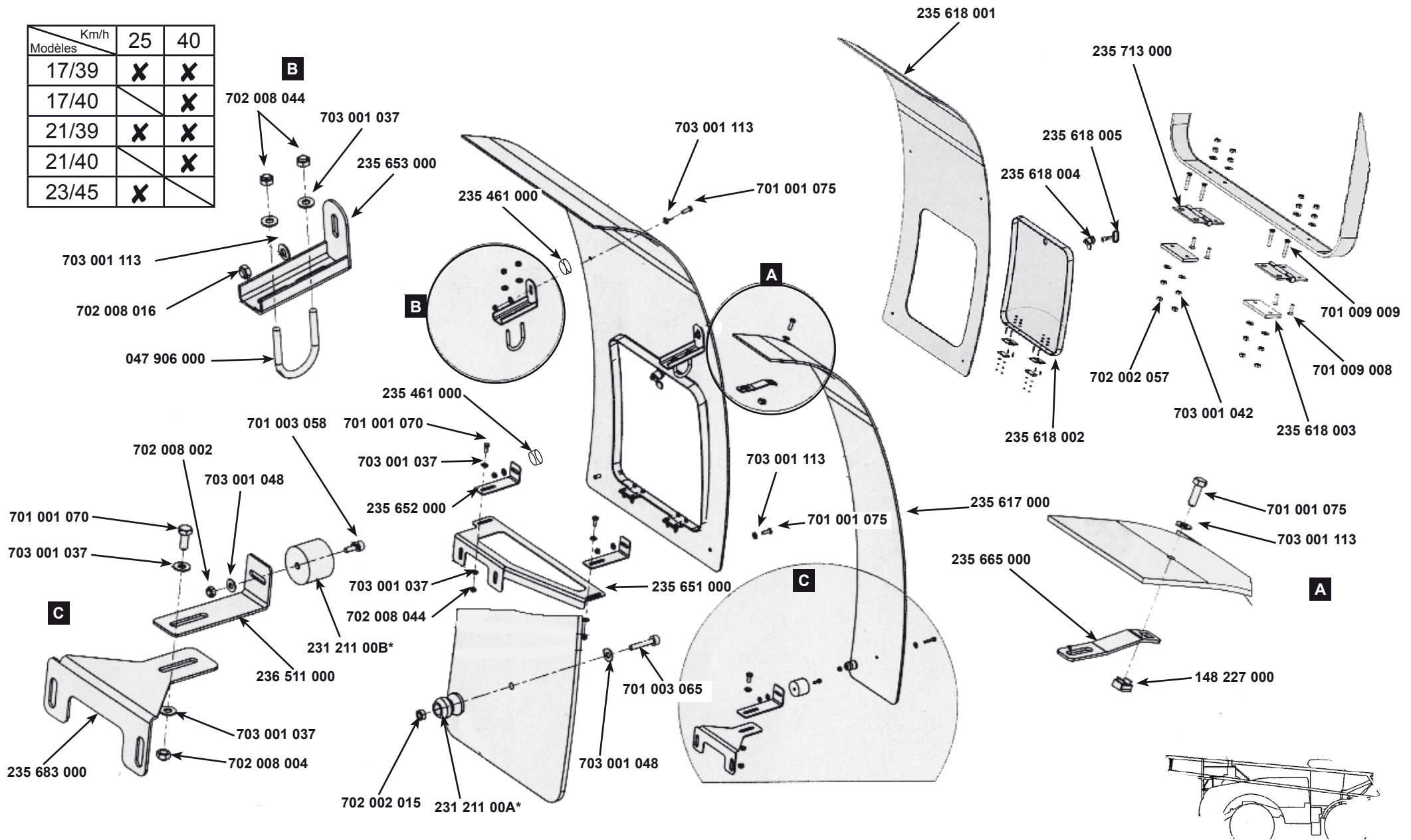

* 231 211 00A + 231 211 00B = 231 211 000

<p>CARTER ARRIÈRE ÉQUIPÉ REAR HOUSING</p>		<p>10 G01 31/05/05</p>
-----------------------------------------------	---------------------------------------------------------------------------------------	--------------------------------

**CATALOGUE MAESTRIA
RAMPE AV 2004**

Correctif mars 2009/March 2009 correction

Modèles \ Km/h	25	40
17/39	X	X
21/39	X	X
23/45		

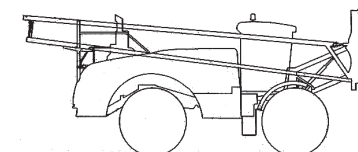
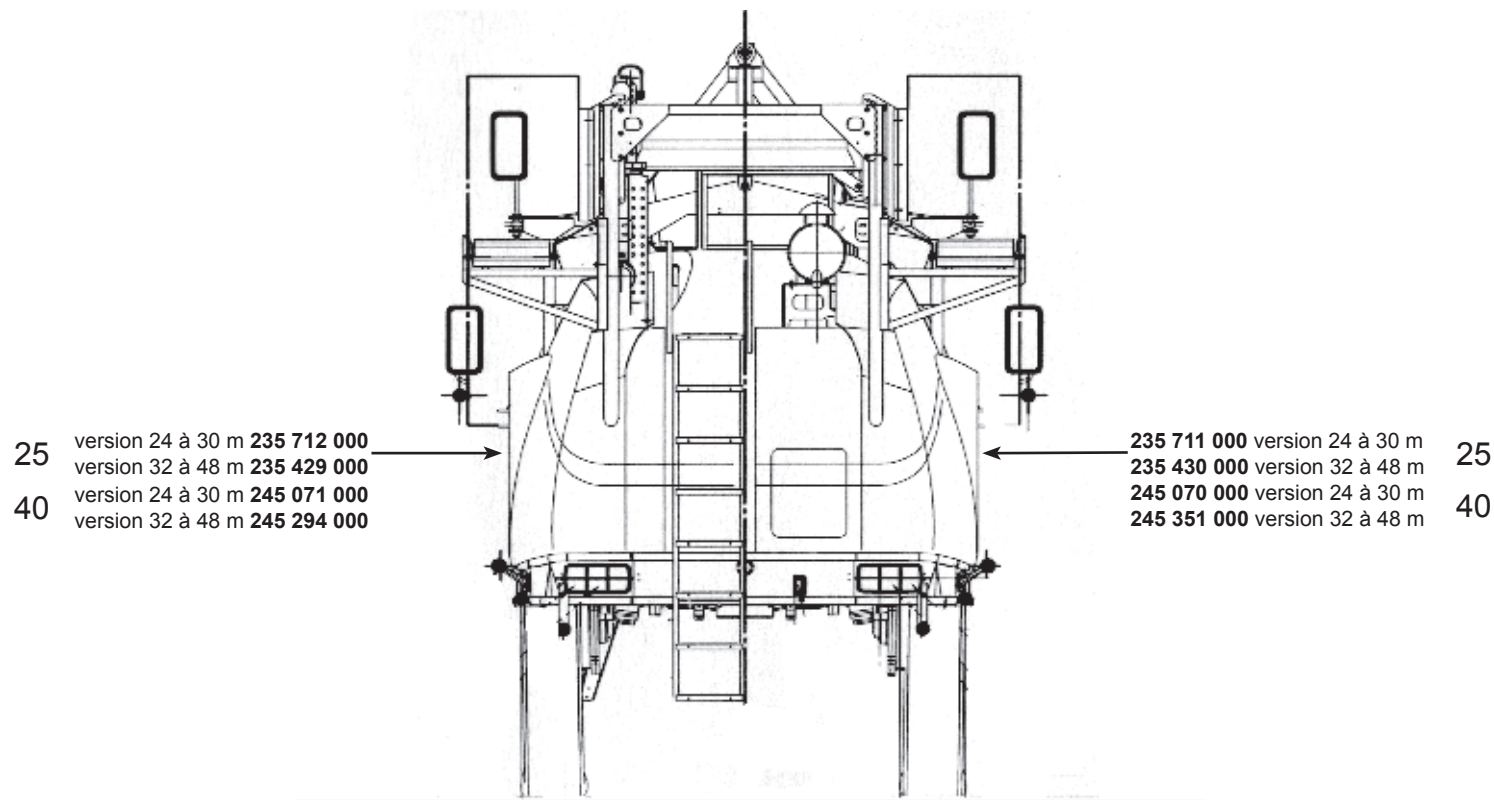

Km/h	25	40
Modèles		
17/39		
21/39		
23/45	X	

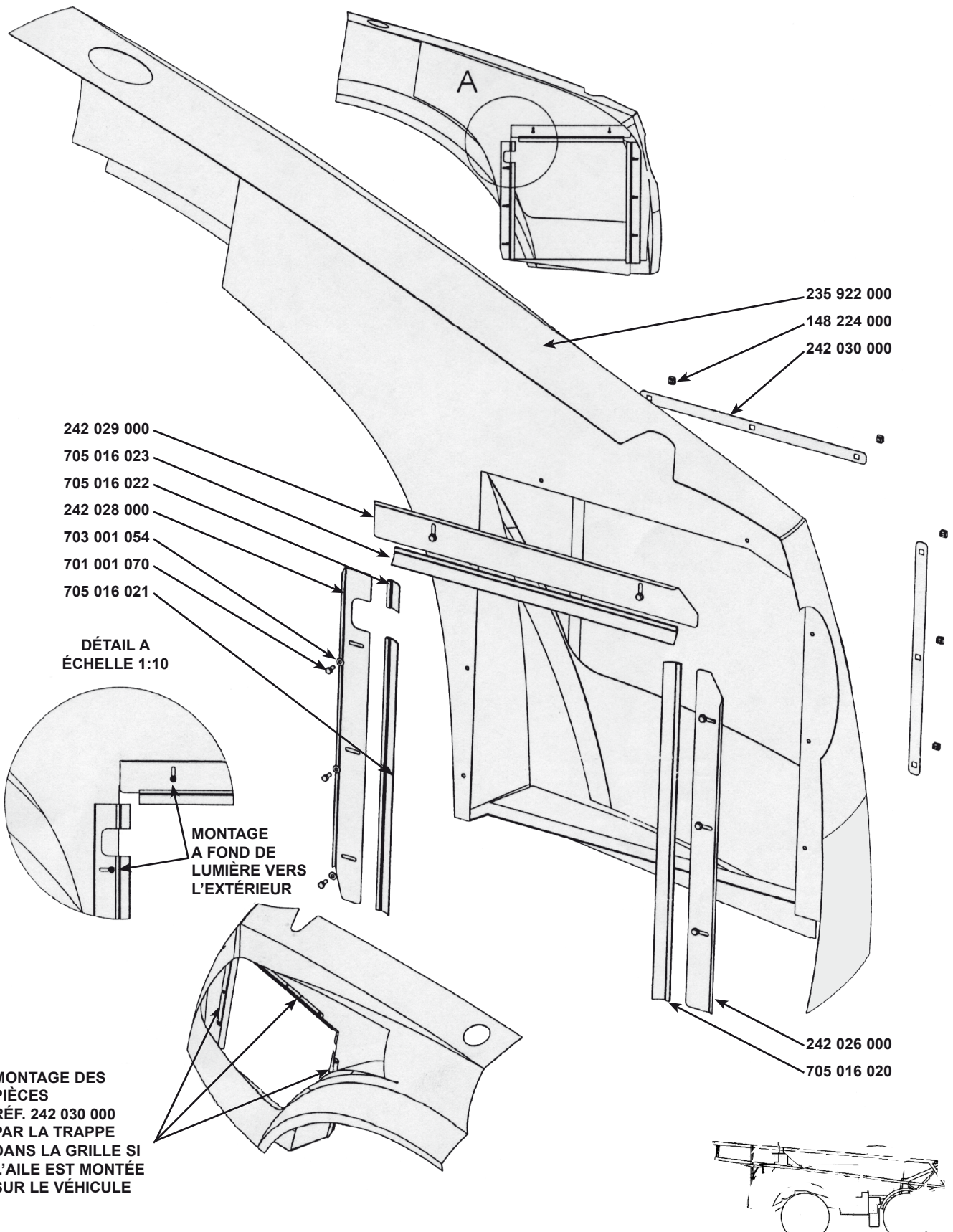

MONTAGE DES
PIÈCES
RÉF. 242 030 000
PAR LA TRAPPE
DANS LA GRILLE SI
L'AILE EST MONTÉE
SUR LE VÉHICULE

DÉTAIL A
ÉCHELLE 1:10

MONTAGE
A FOND DE
LUMIÈRE VERS
L'EXTÉRIEUR

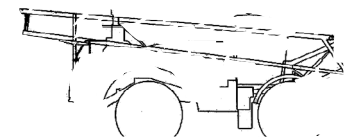
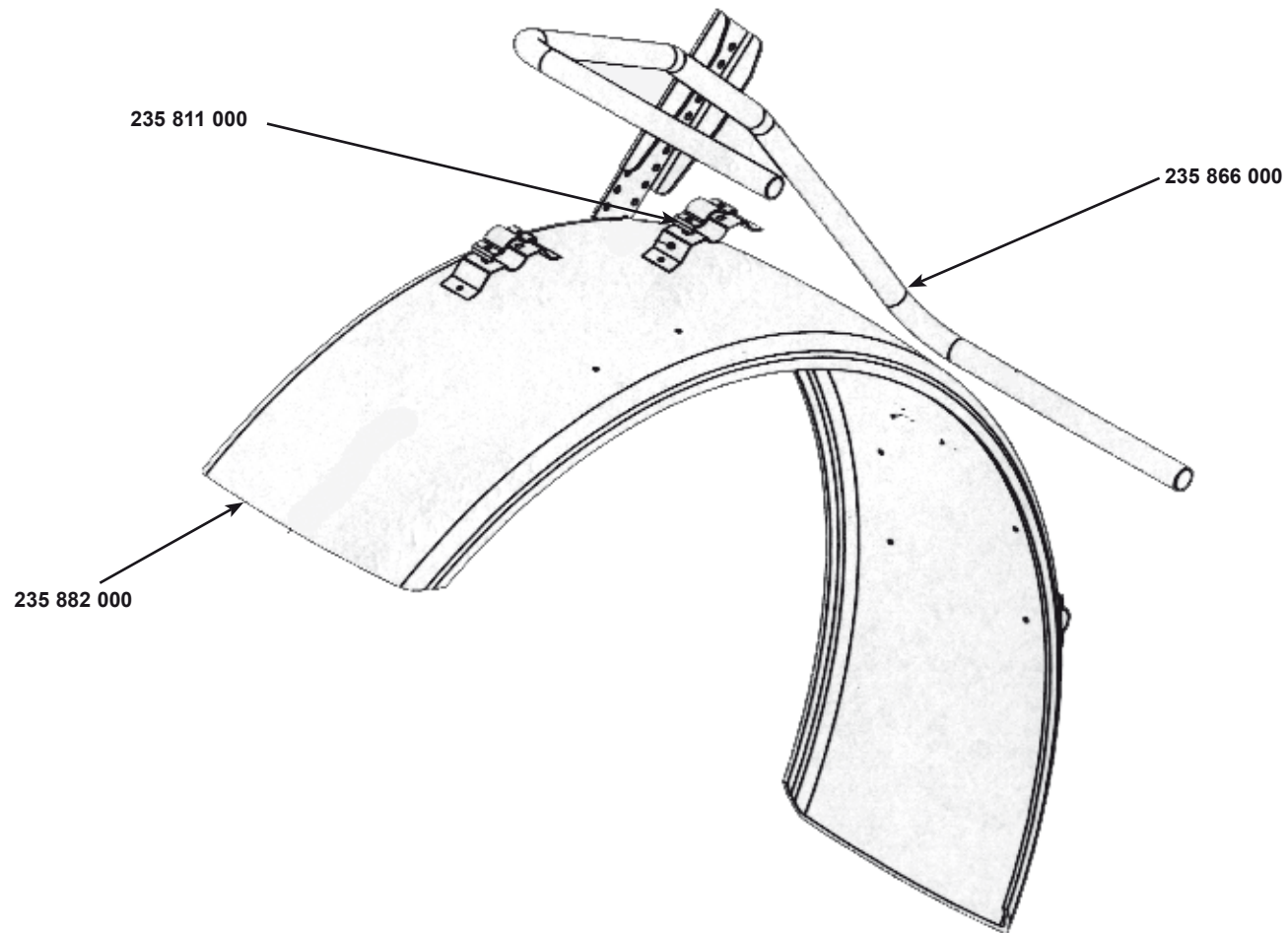

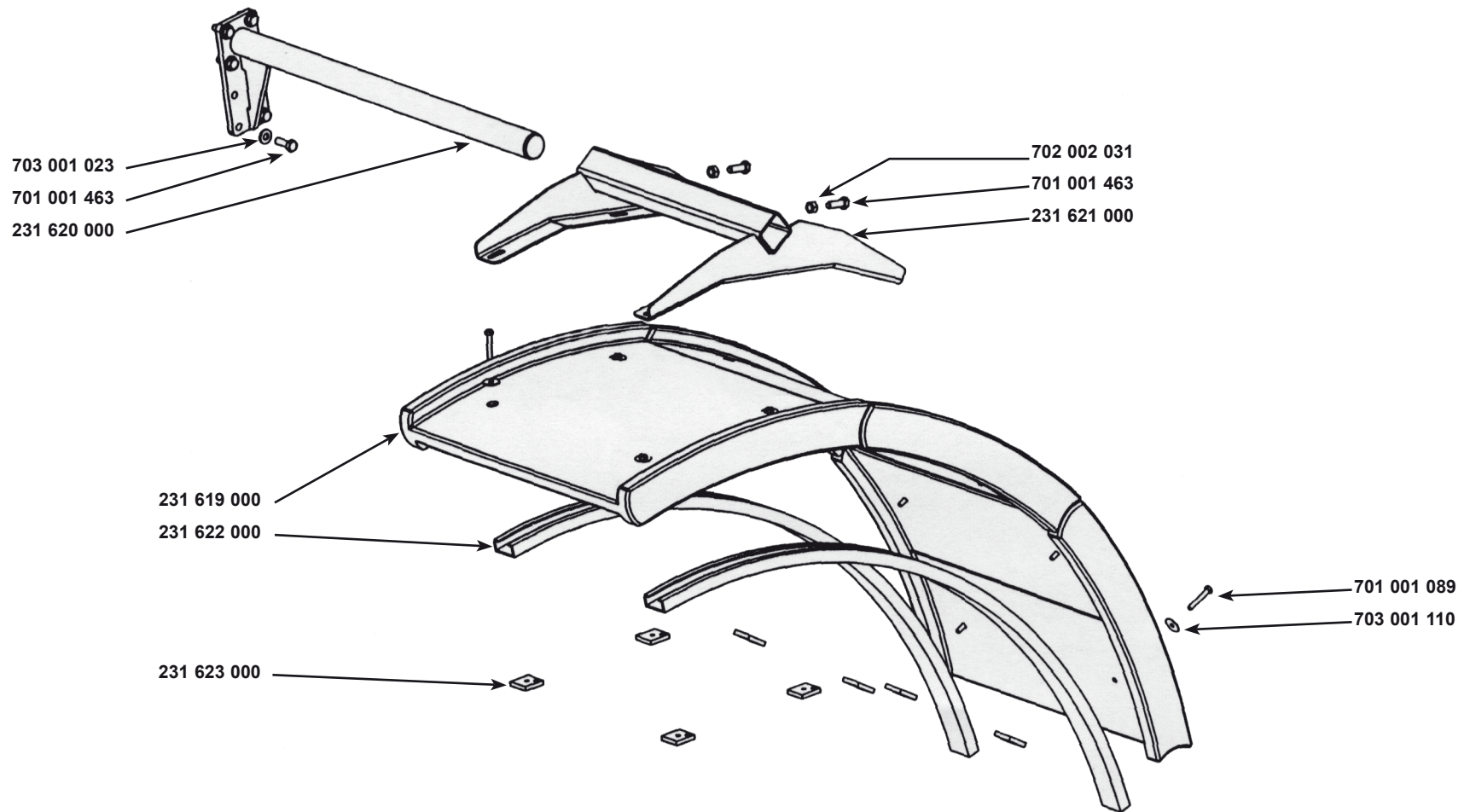

**Ancien modèle
Jusqu'en 2003**

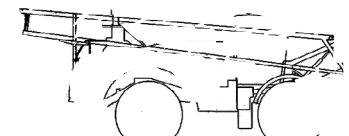

Modèles \ Km/h	25	40
17/39	X	X
17/40		X
21/39	X	X
21/40		X
23/45	X	

Par diviseur / By divider :
 701 001 149 (x9) Vis/Screw
 702 008 019 (x9) Écrou/Nut
 703 001 039 (x18) Rondelle/Washer

Support diviseur gauche
Bracket for left divider
 241 147 000

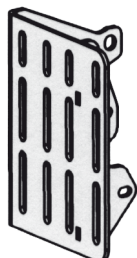

Support diviseur droit
Bracket for right divider
 241 146 000



Diviseur gauche / Left divider
 241 142 000

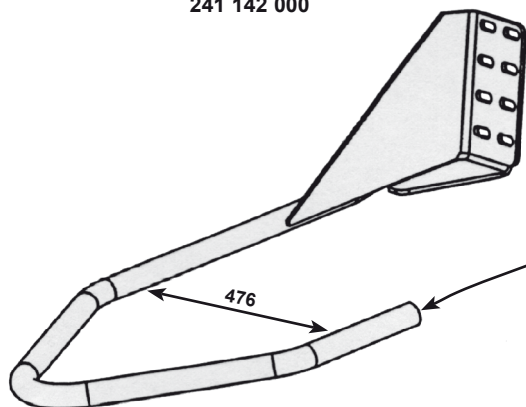

Diviseur droit / Right divider
 241 141 000

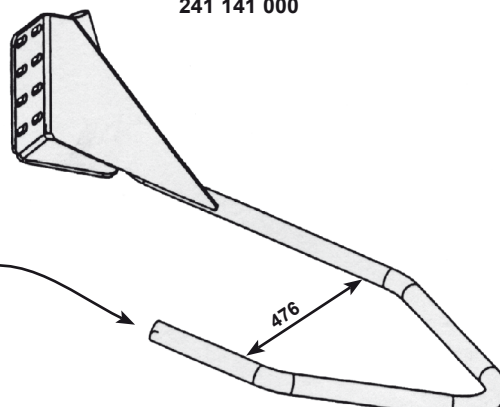

Diviseur gauche large
Wide left divider
 241 144 000

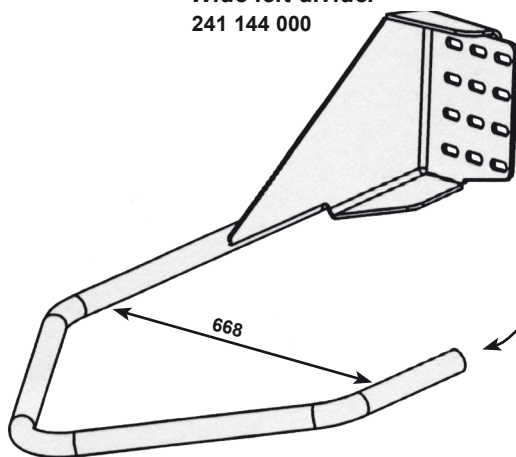

Diviseur droit large
Wide right divider
 241 143 000

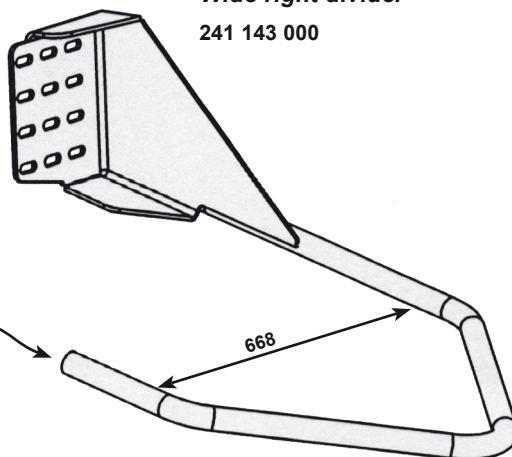

Bouchon pour diviseurs / Cap for divider
 241 155 000

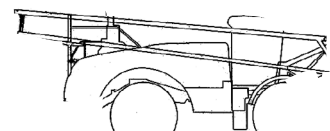

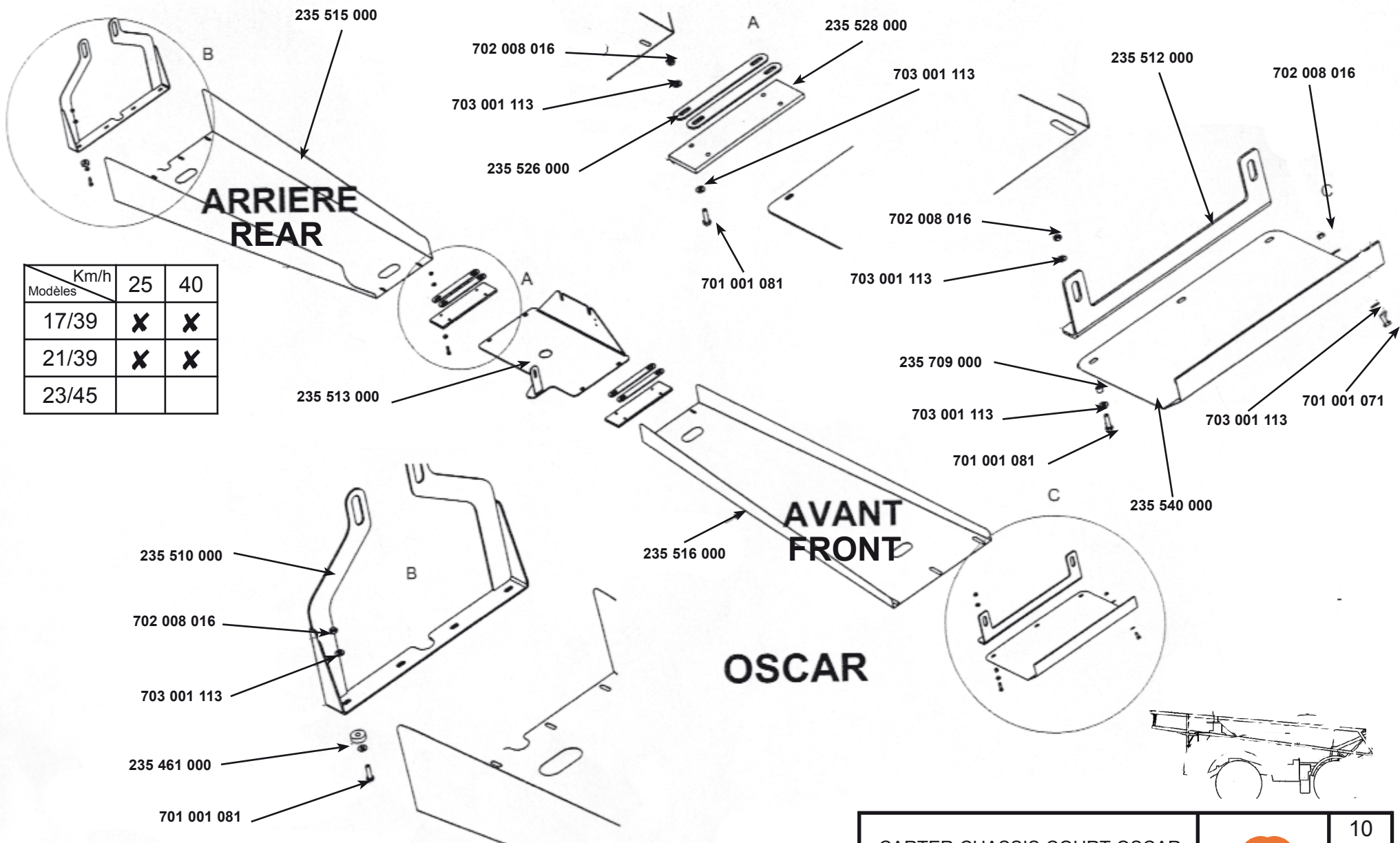

Km/h	25	40
17/39	X	X
21/39	X	X
23/45		

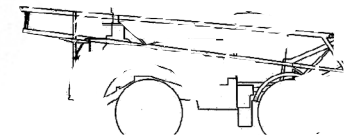

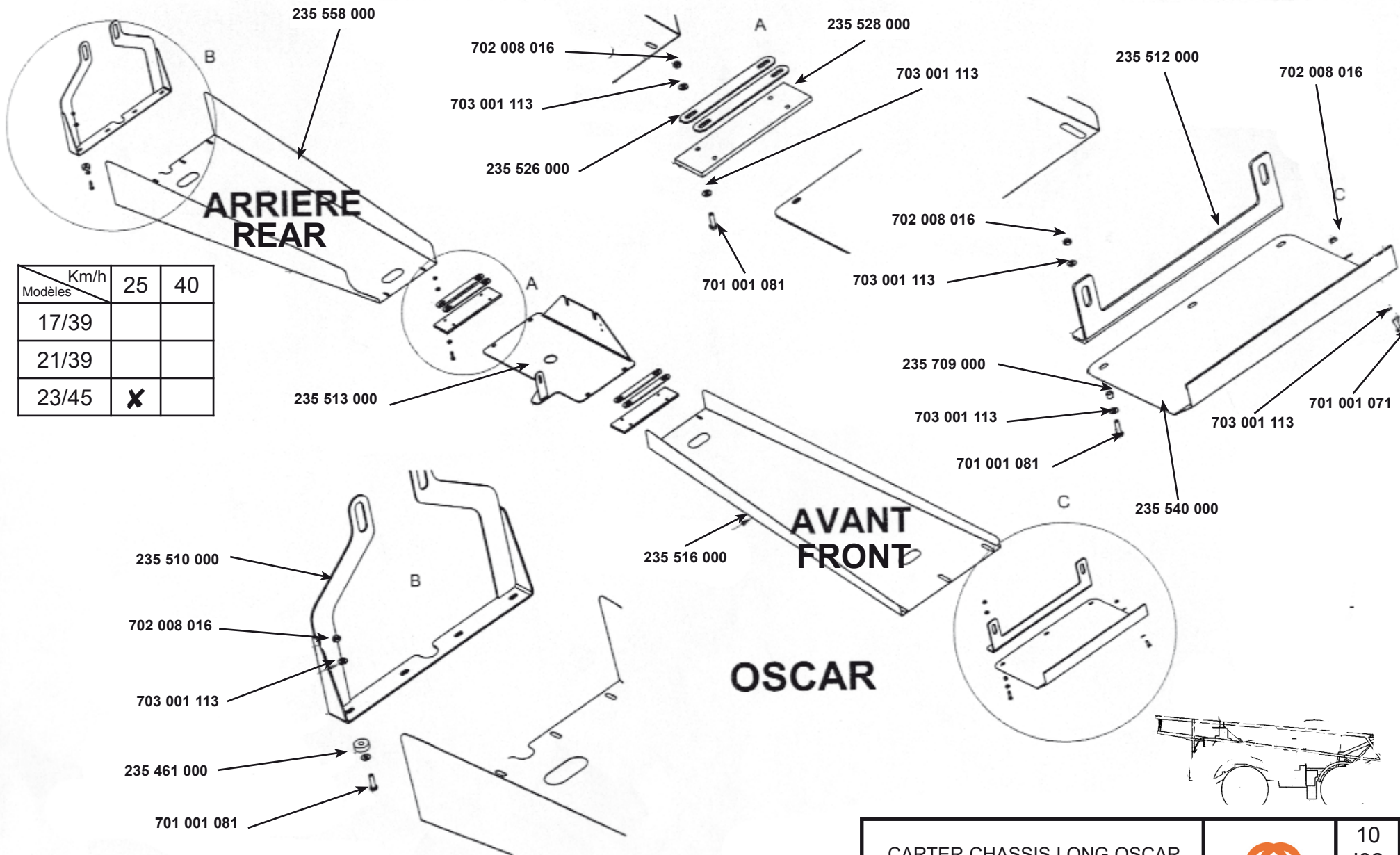

Km/h	25	40
17/39		
21/39		
23/45	X	

Km/h	25	40
17/39	X	X
21/39	X	X
23/45		

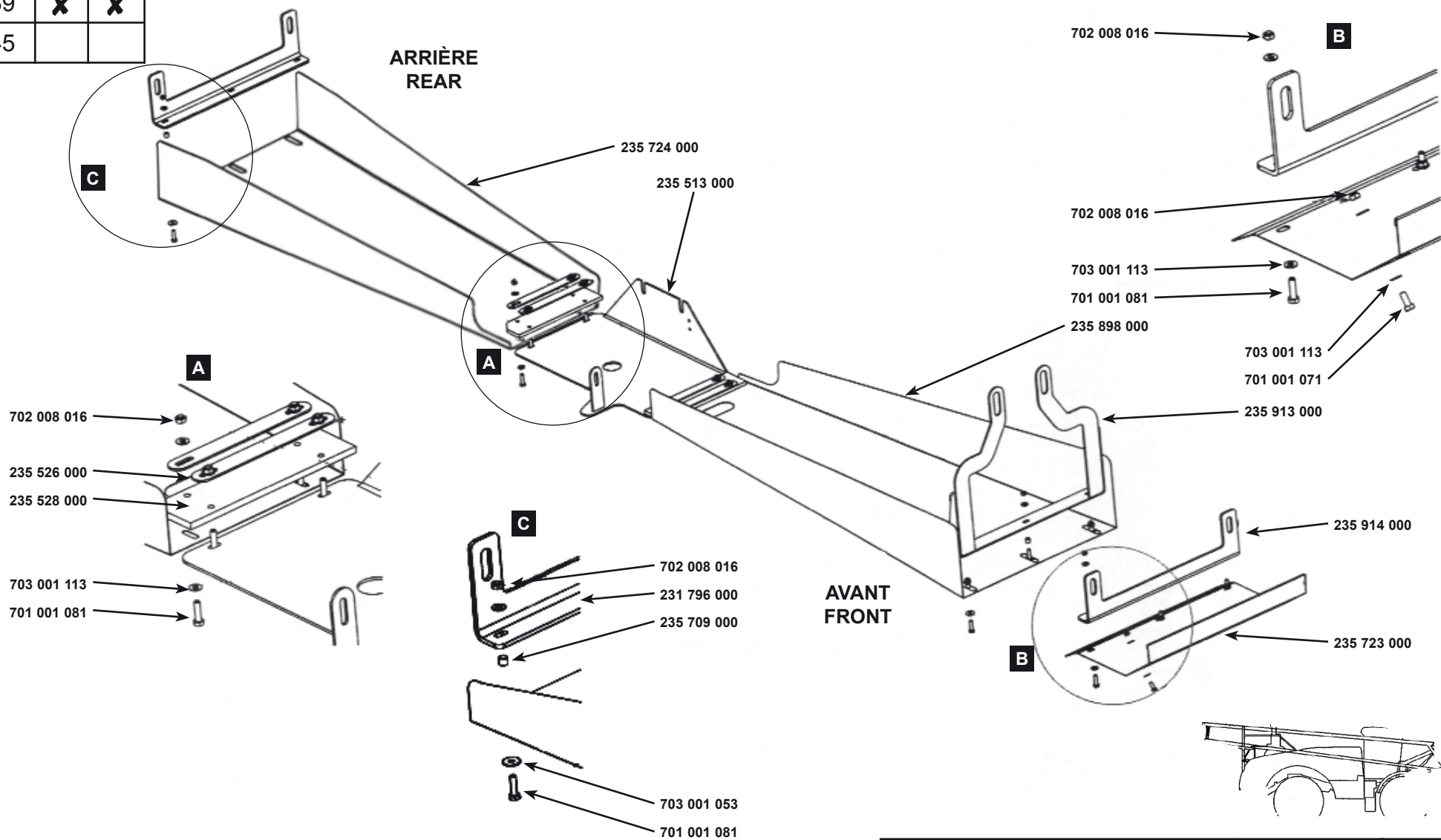

CATALOGUE MAESTRIA
RAMPE AV 2004
 Ajout mars 2006/March '06 Add-on

CARTER CHASSIS COURT STABILIS®
 STABILIS® SHORT FRAME HOUSING



10
 105
 28/03/06

Km/h Modèles	25	40
17/39		
21/39		
23/45	X	

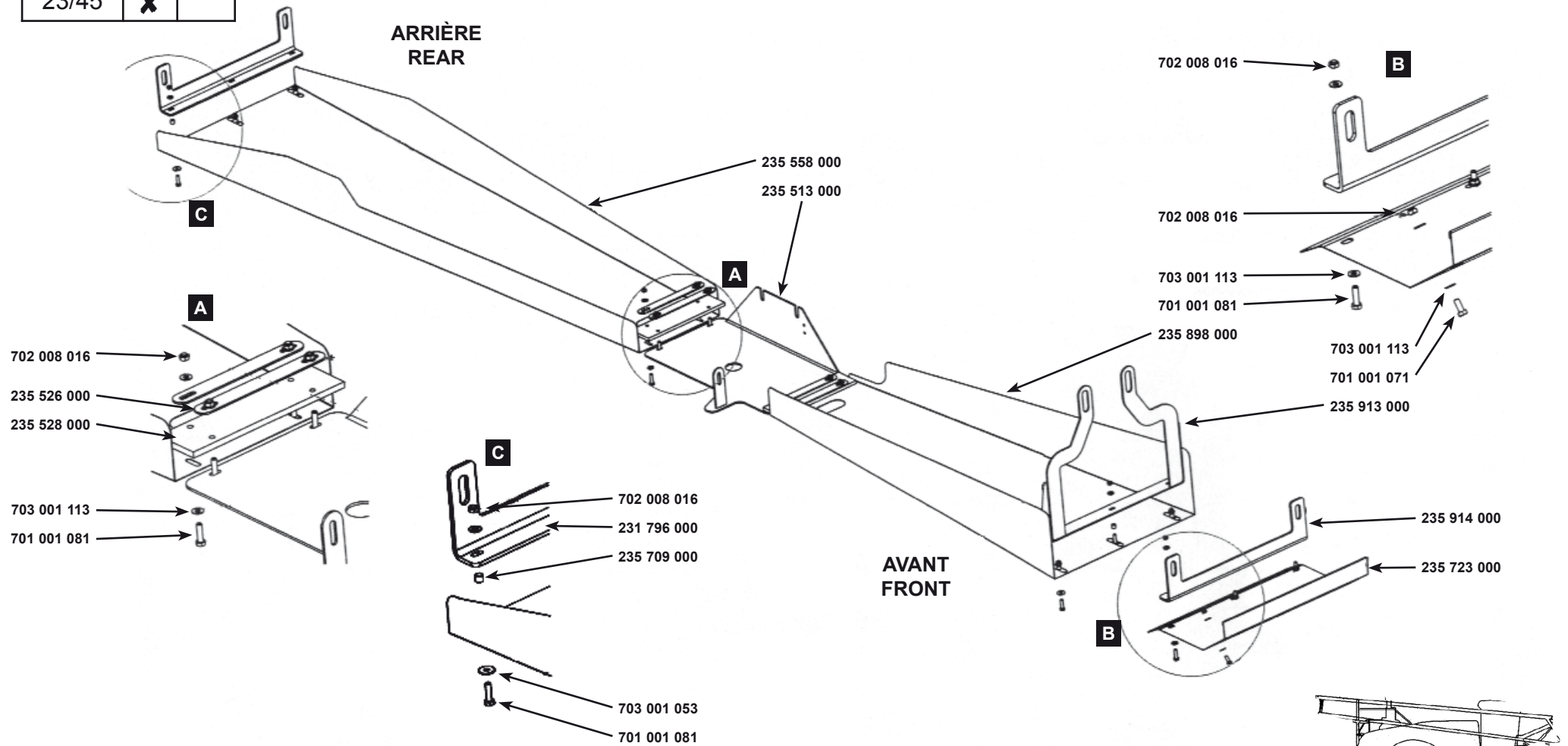

CATALOGUE MAESTRIA
RAMPE AV 2004
 Ajout mars 2006/March '06 Add-on